

Superwand DS[®]

Insulation board for the
inside insulation of
outside walls



**Energy saving up to
45% heating costs**



**Against mould and
black spots**

Buildings with a poor basic structure in Germany, Switzerland and Austria often have not just high energy losses but also unpleasant interior conditions in some cases and suffer from mould growth, particularly at thermal bridges.

Using our Superwand DS[®] insulation boards not only reduces energy losses but also improves the conditions on the surface and the room air.



What Superwand DS[®] has to offer:

- ⊙ The **integrated aluminium** foil acts as a vapour barrier and prevents any later development of mould behind the insulation
- ⊙ Requires **little space** (only 10 mm or 20 mm) with maximum thermal insulation
- ⊙ **Saves energy costs** thanks to the high thermal insulation value
- ⊙ Allows **low-cost renovation work** since no changes are needed to doors, windows, etc.
- ⊙ Can be wallpapered, painted or plastered with **no problems**
- ⊙ **Tried and tested for 25 years** in Switzerland and 8 years in Germany

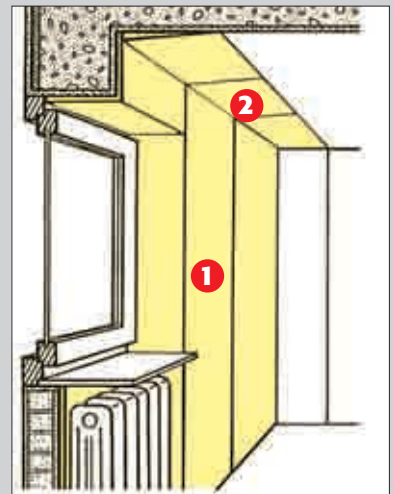

1 Superwand DS[®]

2 UNIVERSAL insulating wedge

Test evaluation by the Fraunhofer Institute for Building Physics

The following values were determined in a model example with a very basic structure

Monthly and annual heating energy needs

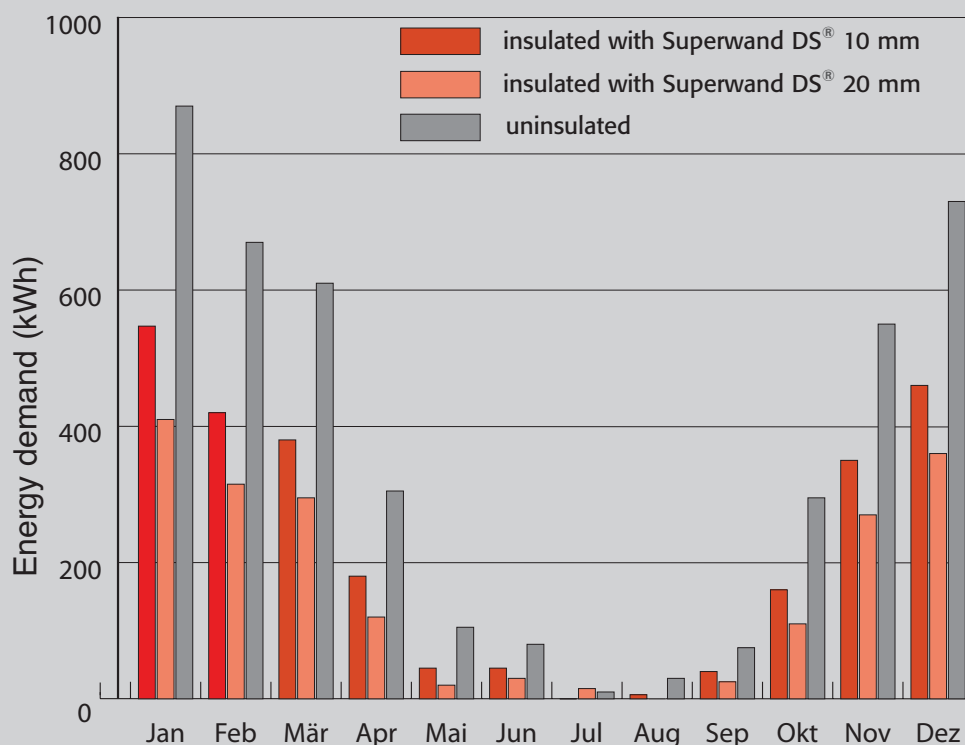

Annual heating energy demand:
 2'614 kWh (with 10 mm)
 2'014 kWh (with 20 mm)
 4'343 kWh (uninsulated)

The chart shows that with a very poor basic structure ($U\text{-value} > 2.0 \text{ W/m}^2\text{K}$) energy savings of up to 45% are possible.

We kindly request

- free advice on Superwand DS[®]
- samples and prices
- further information

KORFF AG
 Niedermattstrasse 35
 CH-4538 Oberbipp BE

Phone +41(0)32 636 33 32
 Fax +41(0)32 636 23 09
 info@korff.ch | www.korff.ch